

**SK41**  
Flanged Cast Steel Ball Valve

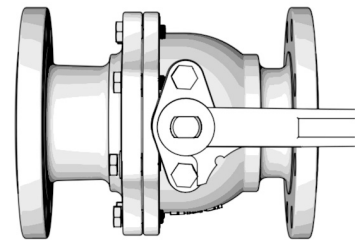

Series SK41	
Size Range	15mm~600mm (1/2"~24")
Body Style	Flanged
Temperature Range	-46°C~180°C
Pressure Range	1.0Mpa~6.3Mpa (Class150~600)
Body Materials	WCB, LCC, WC6, CF8, CF8M, 321, 316Ti, 310S
Ball Materials	304, 316, 310S
Stem Materials	420, 35CrMoA, F6a, F11, F304, F316, F321
Seat Materials	PTFE, PFA, PPL, PEEK, metal to metal
Installation Direction	Bidirectional
Face to Face	GB/T12221, ASME B16.10
Design	GB/T12235, API608
Flange Drilling	ASME B16.5, EN1092, GOST33259
Top connection	ISO5211, GOST55510
Inspection	GB/T13927, ISO5028, API598, JB/T9092

S	K(Type)	x(Driving)	4(Connection)	1(Structure)	P(Sealing material)	-	16(Pressure)	C(Body material)
Seallon	K-ball valve	x-handle 0-yoke 3-gear box 6-pneumatic 9-electric	4- flanged	1-floating	P-plastic S-stainless steel	-	10 16 25 40 63	C-cast steel S-stainless steel

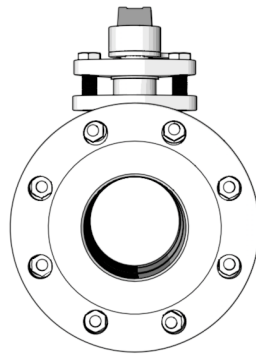
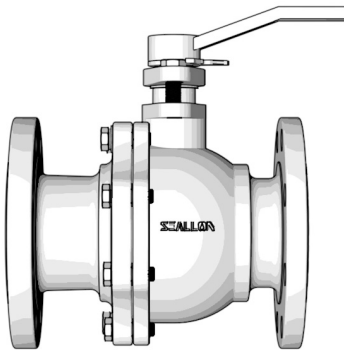

DN	15	20	25	32	40	50	65	80	100	125	150	200	250	300	350	400	450	500	600
L (F-F PN16, mm)	130	140	150	165	180	200	220	250	280	320	360	400	450	500	550	600	650	700	800
L (F-F 150LB, mm)	108	117	127	140	165	178	190	203	229	356	394	457	533	610	686	762	864	914	1067
Torque (1.6Mpa)	3	5	10	14	16	25	50	65	125	250	340	485	810	1310	1910	2860	4500	5860	8920
Torque (2.5Mpa)	3	5	11	16	18	30	60	80	140	300	400	680	1140	1870	2740	4150	6500	7800	13210
Torque (4.0Mpa)	5	10	24	30	35	50	100	150	250	450	585	996	1690	2800	4110	6300	8900	12000	20380
Bare stem weight (kg)	2.7	3.3	4	5.5	7	9	12.5	15.5	21	29	42	66	122	165	335	505			