

Series SK41-P	
Size Range	15mm~600mm (1/2"~24")
Body Style	Flanged
Temperature Range	-46°C~180°C
Pressure Range	1.0Mpa~1.6Mpa (Class150)
Body Materials	WCB, CF8, CF8M
Ball Materials	WCB+PTFE, 304+PFA
Stem Materials	420, F6a, F304, F316
Seat Materials	FEP, PTFE, PFA
Installation Direction	Bidirectional
Face to Face	GB/T12221, ASME B16.10
Design	GB/T12235, API608
Flange Drilling	ASME B16.5, EN1092, GOST33259
Top connection	ISO5211, GOST55510
Inspection	GB/T13927, ISO5028, API598, JB/T9092

**SK41-P**  
Flanged Full-lined Ball Valve

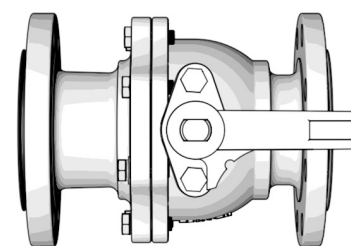

S	K(Type)	×(Driving)	4(Connection)	1(Structure)	P(Sealing material)	-	10(Pressure)	C(Body material)
Seallon	K-ball valve	×-handle 0-yoke 3-gear box 6-pneumatic 9-electric	4- flanged	1-floating	P-plastic	-	10 16	C-cast steel S-stainless steel

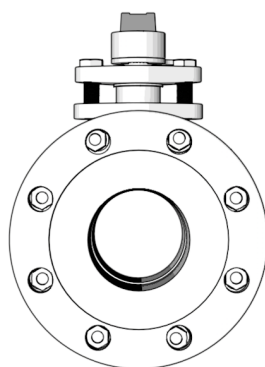
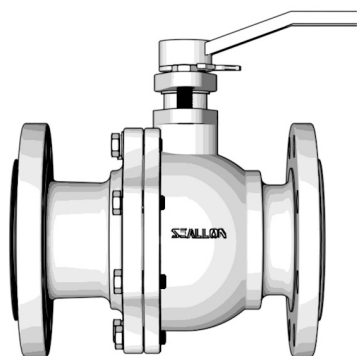

DN	15	20	25	32	40	50	65	80	100	125	150	200	250	300	350	400	450	500	600
L (F-F PN16, mm)	130	140	150	165	180	200	220	250	280	320	360	400	450	500	550	600	650	700	800
L (F-F 150LB, mm)	108	117	127	140	165	178	190	203	229	356	394	457	533	610	686	762	864	914	1067
Torque (1.6Mpa)	3	5	10	14	16	25	50	65	125	250	340	485	810	1310	1910	2860	4500	5860	8920
Bare stem weight (kg)	2.7	3.3	4	5.5	7	9	12.5	15.5	21	29	42	66	122	165	335	505			