

Series SK40	
Size Range	50mm~600mm (2"~24")
Body Style	Flanged
Temperature Range	-59°C~650°C
Pressure Range	1.0Mpa~6.3Mpa (Class150~600)
Body Materials	WCB, LCC, LC1, WC6, CF8, CF8M, 321, 316Ti
Ball Materials	WCB, LCC, LC1, WC6, CF8, CF8M, 321, 316Ti
Stem Materials	420, 35CrMoA, F6a, F11, F304, F316, F321
Seat Materials	PTFE, PEEK, 420, Stellite alloy, Hastelloy
Installation Direction	Unidirectional
Face to Face	GB/T12221
Design	GB/T26146
Flange Drilling	ASME B16.5, EN1092, GOST33259, DIN2501
Top connection	ISO5211, GOST55510
Inspection	GB/T13927, ISO5028, API598, JB/T9092

SK40
Flanged Eccentric Hemispherical
Ball Valve

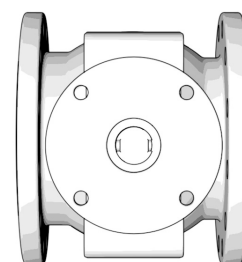

S	K(Type)	0(Driving)	4(Connection)	0(Structure)	P(Sealing material)	-	10(Pressure)	C(Body material)
Seallon	K-ball valve	x-handle	4- flanged	0-eccentric hemispherical	P-PTFE	-	10	C-cast steel
		0-yoke			S-stainless steel		16	S-stainless steel
		3-gear box					25	
		6-pneumatic					40	
		9-electric					63	

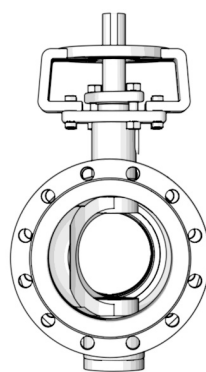
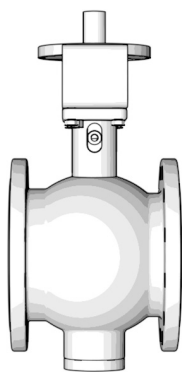

DN	50	65	80	100	125	150	200	250	300	350	400	450	500	600
L (F-F, mm)	178	190	203	229	254	267	292	330	356	430	530	580	630	800
Torque (1.6Mpa)	30	50	65	125	250	340	485	810	1310	1910	2860	4500	5860	7325
Bare stem weight (kg)	15	18	22	24	30	38	56	80	108	140	206	262	318	470