

Series SK11	
Size Range	15mm~100mm (1/2"~4")
Body Style	Threaded, welded, flanged
Temperature Range	-59°C~200°C
Pressure Range	1.0Mpa~6.3Mpa (Class150~600)
Body Materials	CF8, CF8M, 321, 316Ti, 310S, Duplex Stainless Steel
Ball Materials	304, 316, 310S
Stem Materials	420, 35CrMoA, F6a, F11, F304, F316, F321
Seat Materials	PTFE, PFA, PPL, PEEK
Installation Direction	Bidirectional
Face to Face	GB/T12221, ASME B16.10
Design	GB/T8464
Flange Drilling	ASME B16.5, EN1092, GOST33259
Top connection	ISO5211, GOST55510
Inspection	GB/T13927, ISO5028, API598, JB/T9092

SK11
Threaded Cast Steel Ball Valve

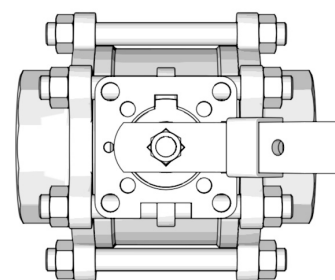

S	K(Type)	×(Driving)	1(Connection)	1(Structure)	P(Sealing material)	- 16(Pressure)	S(Body material)
Seallon	K-ball valve	×-handle 0-yoke 3-gear box 6-pneumatic 9-electric	1- female 2-male 4-flanged 6-welded	1-1 piece 2-2 pieces 3-3 pieces	P-plastic	- 10 16 25 40 63	S-stainless steel C-cast steel

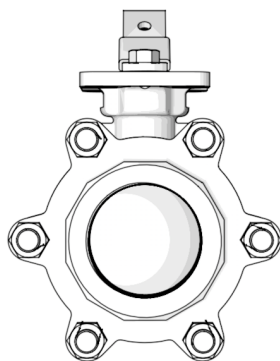
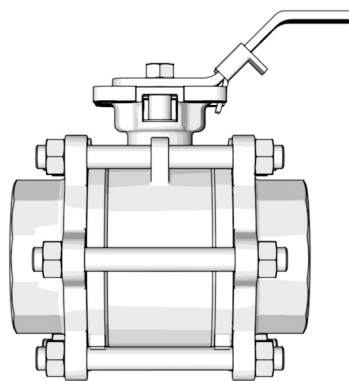

DN	15	20	25	32	40	50
L (F-F, mm)	72	79	85	111	119	130
Torque (1.6~4.0Mpa)	5	10	24	30	35	50
Bare stem weight (kg)	0.6	0.75	1.2	1.9	2.3	3