

SGL61-F	
Size Range	15mm~50mm (1/2"~2")
Body Style	Welded, threaded
Temperature Range	-46°C~650°C
Pressure Range	1.0Mpa~16.0Mpa (Class150~2500)
Body Materials	A105, LF2, F11, F51, F91, F304, F316
Disc Materials	A105, LF2, F11, F51, F91, F304, F316
Stem Materials	410, F6a, F51, F91, F304, F316
Seat Materials	410, 410HF, F51, F91, F304, F316
Installation Direction	Unidirectional
Face to Face	GB/T12221, ASME B16.10, Customized
Design	GB/T12234, API602, ASME B16.34
Flange Drilling	ASME B16.5, EN1092, GOST33259
Top connection	ISO5211, GOST55510
Inspection	GB/T26480, ISO5028, API598, JB/T9092

SGL61-F
Welded Forged Steel Globe Valve

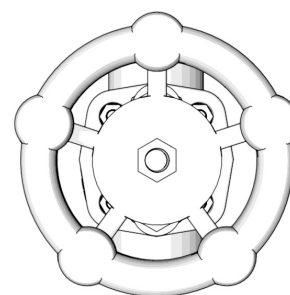

S	GL(Type)	×(Driving)	6(Connection)	1(Structure)	S(Sealing material)	- 16(Pressure)	C(Body material)
Seallon	GL-globe valve	×-handwheel	6-welded 1-threaded	1-pass through	S-stainless steel	- 10	C-forged steel S-stainless steel
		0-yoke				- 16	
		5-gear box				- 25	
		6-pneumatic				- 40	
		9-electric				- 63	

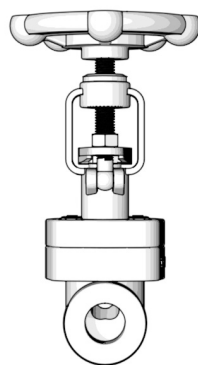
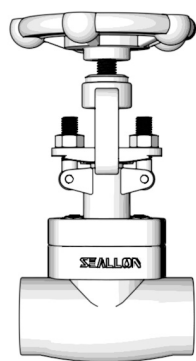

DN	15	20	25	32	40	50
L (F-F PN16~40, mm)	140	150	165	178	200	250
L (F-F 150LB, mm)	108	117	127	140	165	178
L (F-F 300LB, mm)	140	152	165	178	190	216
L (F-F 600LB, mm)	165	190	216	229	241	292
Torque (1.6~4.0Mpa)	35	35	35	35	35	60
Weight (kg)	3.5	4	6.2	7.2	10.4	15.5