

Series SG61-F	
Size Range	15mm~50mm (1/2"~2")
Body Style	Welded, threaded
Temperature Range	-46°C~650°C
Pressure Range	1.0MPa~16.0MPa (Class150~2500)
Body Materials	A105, LF2, F11, F51, F91, F304, F316
Disc Materials	A105, LF2, F11, F51, F91, F304, F316
Stem Materials	410, F6a, F51, F91, F304, F316
Seat Materials	410, 410HF, F51, F91, F304, F316
Installation Direction	Bidirectional
Face to Face	GB/T12221, ASME B16.10, Customized
Design	GB/T12234, API602, ASME B16.34
End connection	ASME B16.11, ASME B16.25, ASME B1.20.1 (NPT)
Top connection	ISO5211, GOST55510
Inspection	GB/T26480, ISO5028, API598, JB/T9092

**SG61-F**  
Welded Forged Steel Gate Valve

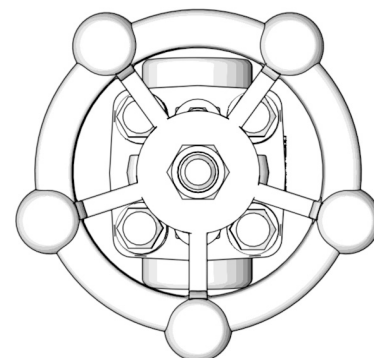

S	G(Type)	×(Driving)	6(Connection)	1(Structure)	R(Sealing material)	- 16(Pressure)	C(Body material)
Seallon	G-gate valve	×-handwheel	6-welded 1-threaded	1-wedged	S-stainless steel	-	C-forged steel
		0-yoke				10	S-stainless steel
		5-gear box				16	
		6-pneumatic				25	
		9-electric				40	
						63	

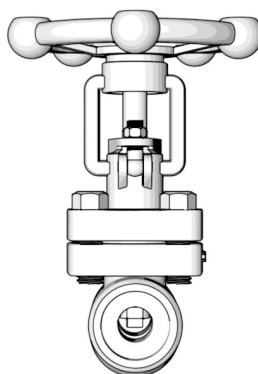
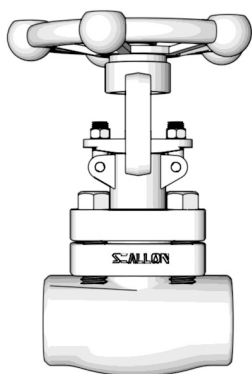

DN	15	20	25	32	40	50
L (F-F PN16~40, mm)	140	150	165	178	200	250
L (F-F 150LB, mm)	108	117	127	140	165	178
L (F-F 300LB, mm)	140	152	165	178	190	216
L (F-F 600LB, mm)	165	190	216	229	241	292
Torque (1.6~4.0Mpa)	35	35	35	35	35	60
Weight (kg)	3.5	4	6.2	7.2	10.4	15.5